

**This electronic collection of documents is provided
for the convenience of the user
and is Not a Certified Document –**

**The documents contained herein were originally issued
and sealed by the individuals whose names and license
numbers appear on each page, on the dates appearing
with their signature on that page.**

**This file or an individual page
shall not be considered a certified document.**

PROJ. REFERENCE NO.	SHEET NO.
BP14.R004	X-0

ISRAEL RD AT DUTCH COVE CREEK

HAYWOOD COUNTY

<u>LINE</u>	<u>SHEET NO.</u>
-L_DET-	X-1 TO X-10
-L-	X-10 TO X-25

8/17/99

3/15/2022
R:\Projects\Corridor-Modeling\RI86.RDY.XPL_INDEX.dgn
David

6/23/16

	PROJ. REFERENCE NO.	SHEET NO.
	BP14.R004	X-1

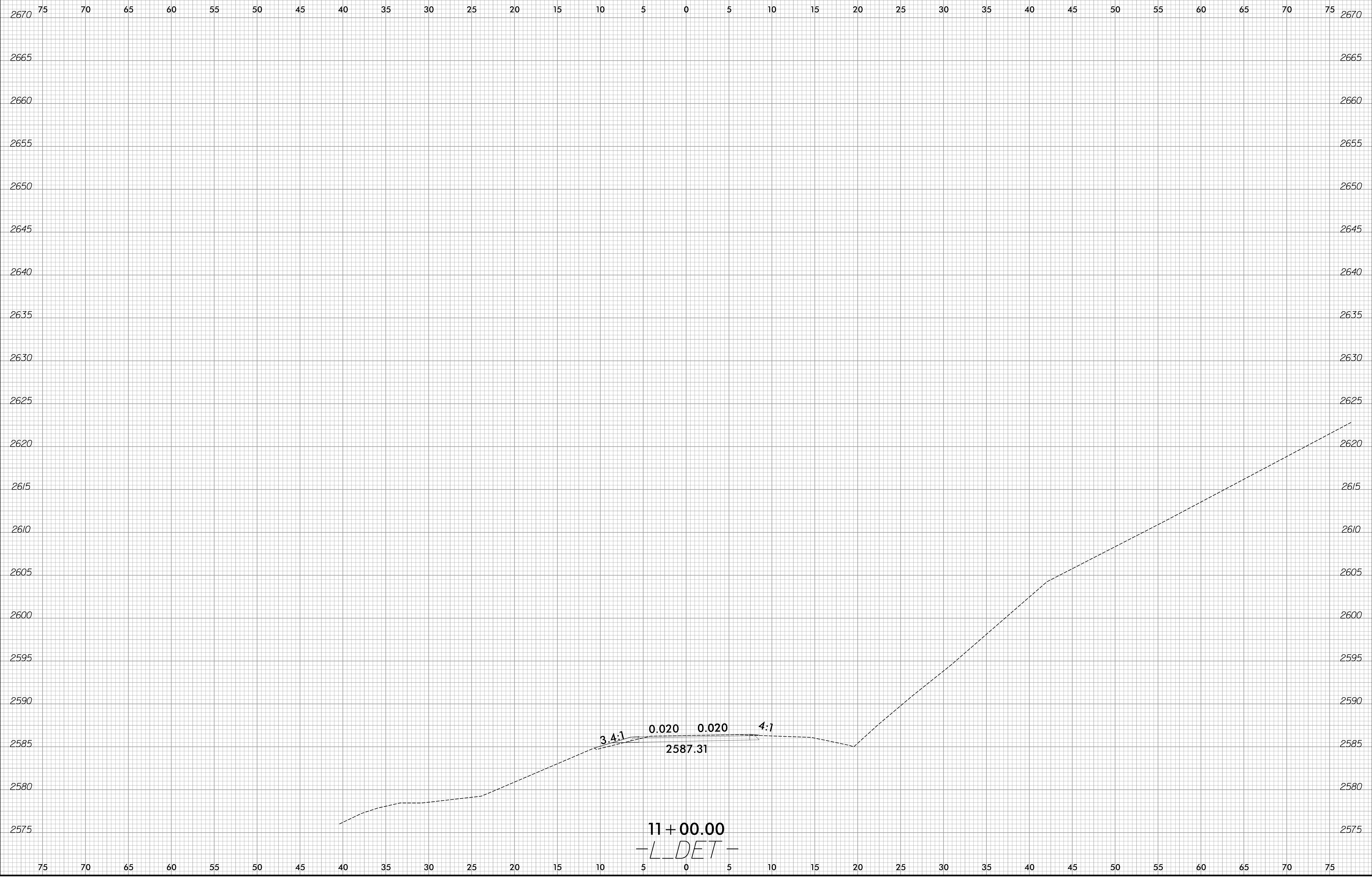

3/15/2022
P:\Roadway\CorridorModeling\RI86_R0Y_XPL_L_DET.dgn
David.Choi

6/23/16

	PROJ. REFERENCE NO.	SHEET NO.
	BP14.R004	X-2

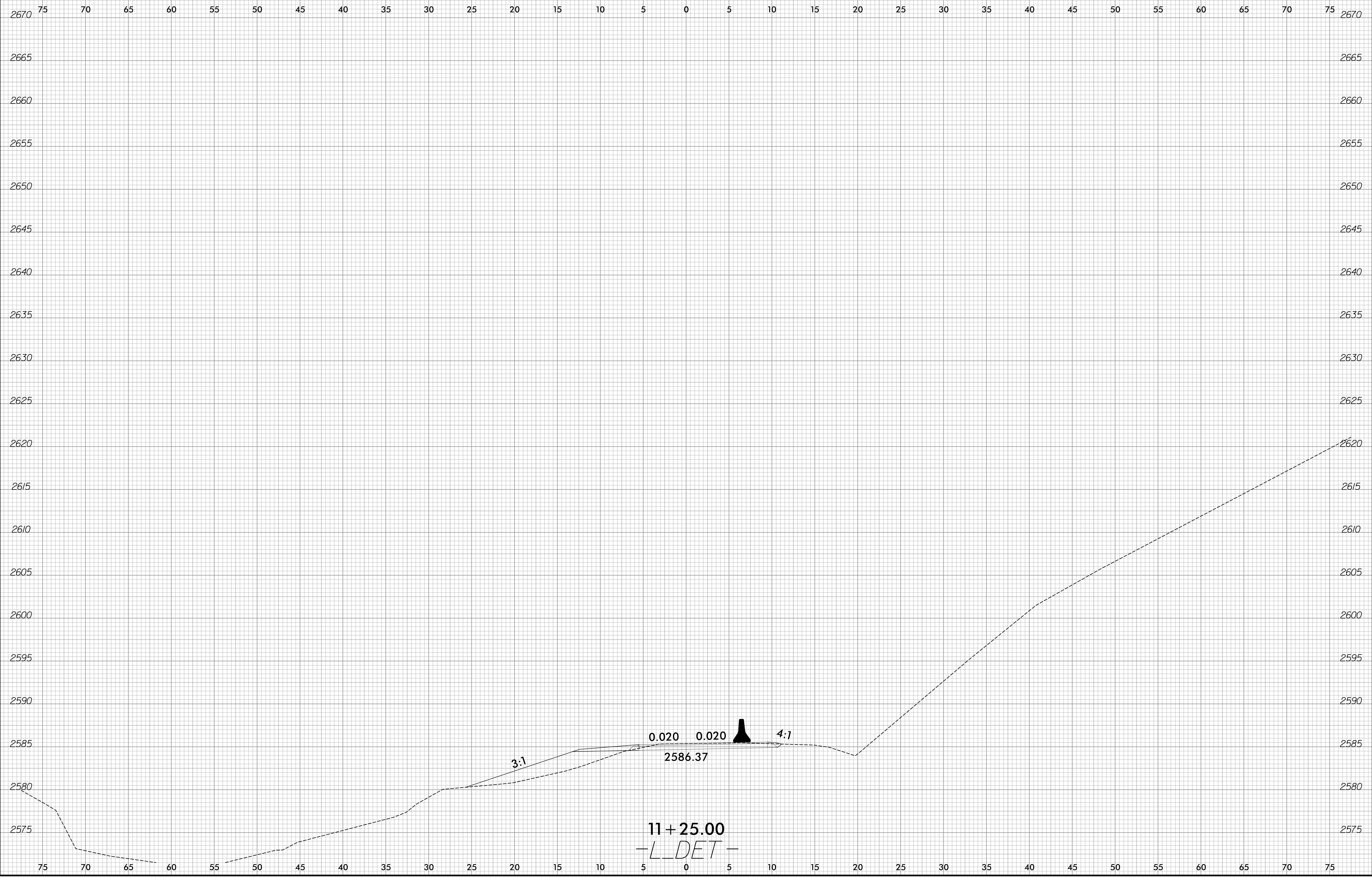

3/15/2022
P:\Roadway\CorridorModeling\RI86_R0Y_XPL_L_DET.dgn
David.Chen

6/23/16

	PROJ. REFERENCE NO.	SHEET NO.
	BP14.R004	X-3

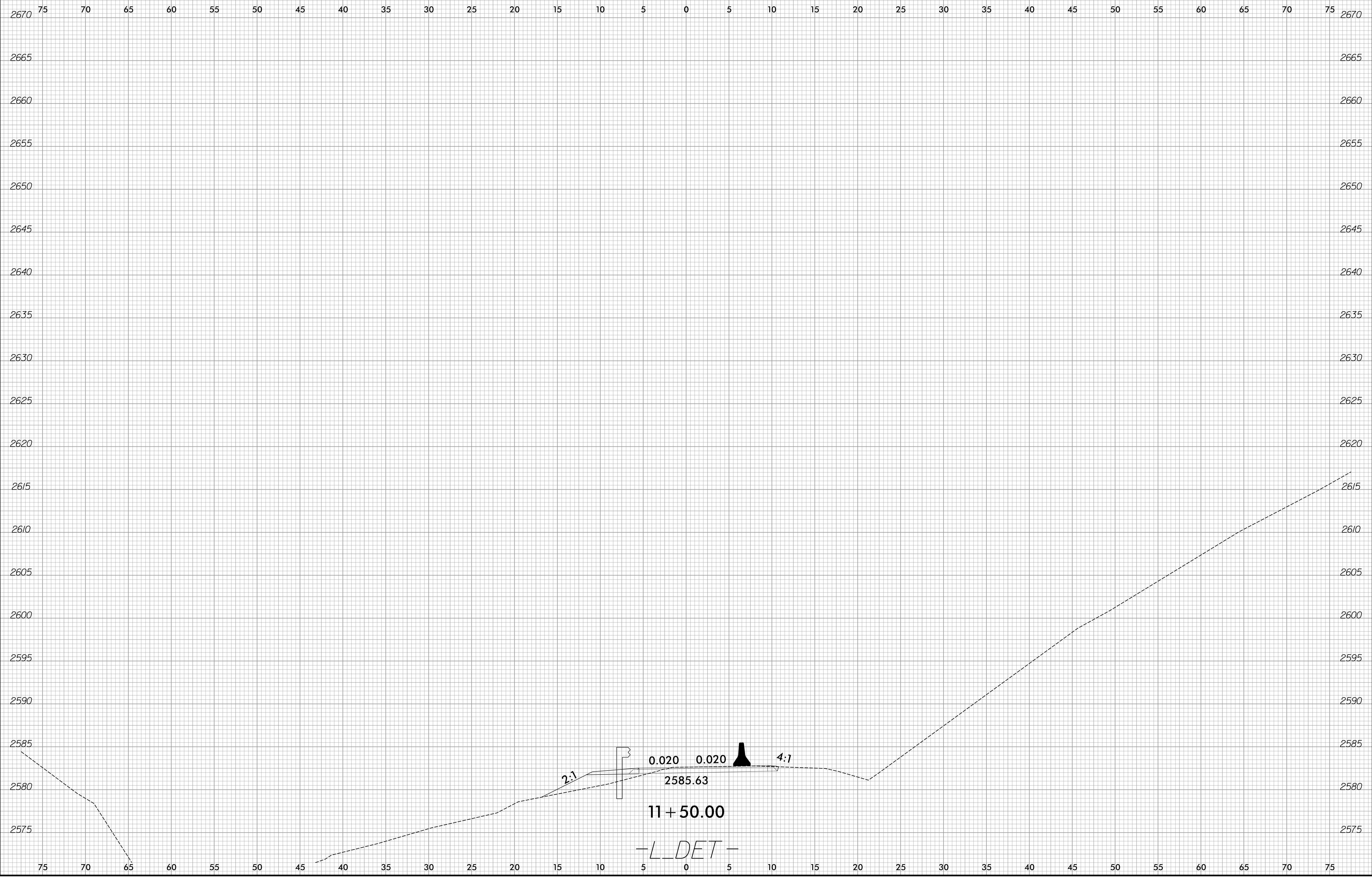

3/15/2022
P:\Roadway\CorridorModeling\RI86_R0Y_XPL_LL_DET.dgn
David.Chilton

6/23/16

	PROJ. REFERENCE NO.	SHEET NO.
	BP14.R004	X-4

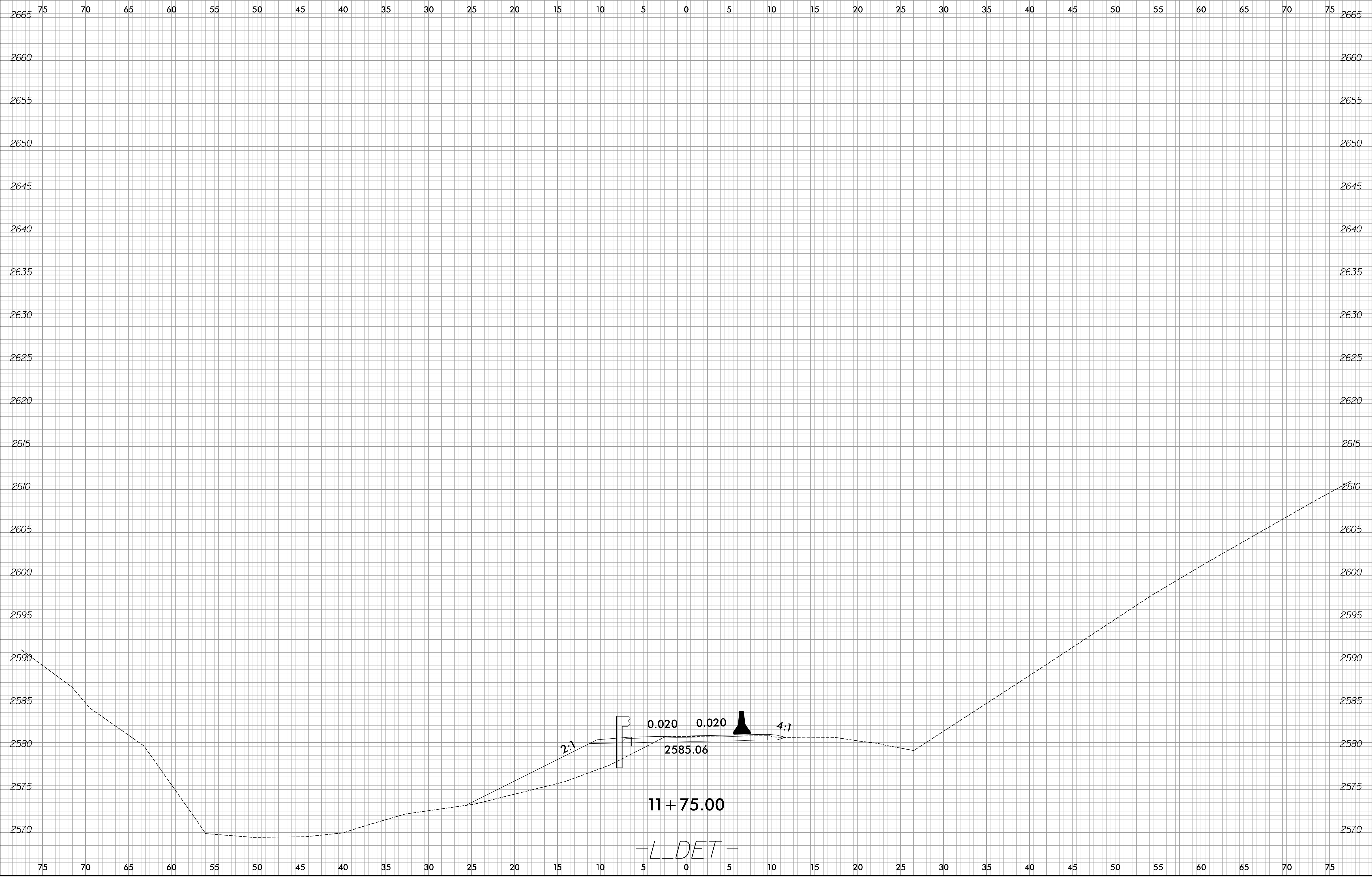

3/15/2022
P:\Roadway\CorridorModeling\RI86_R0Y_XPL_LL_DET.dgn
David.Choi

6/23/16

	PROJ. REFERENCE NO.	SHEET NO.
	BP14.R004	X-5

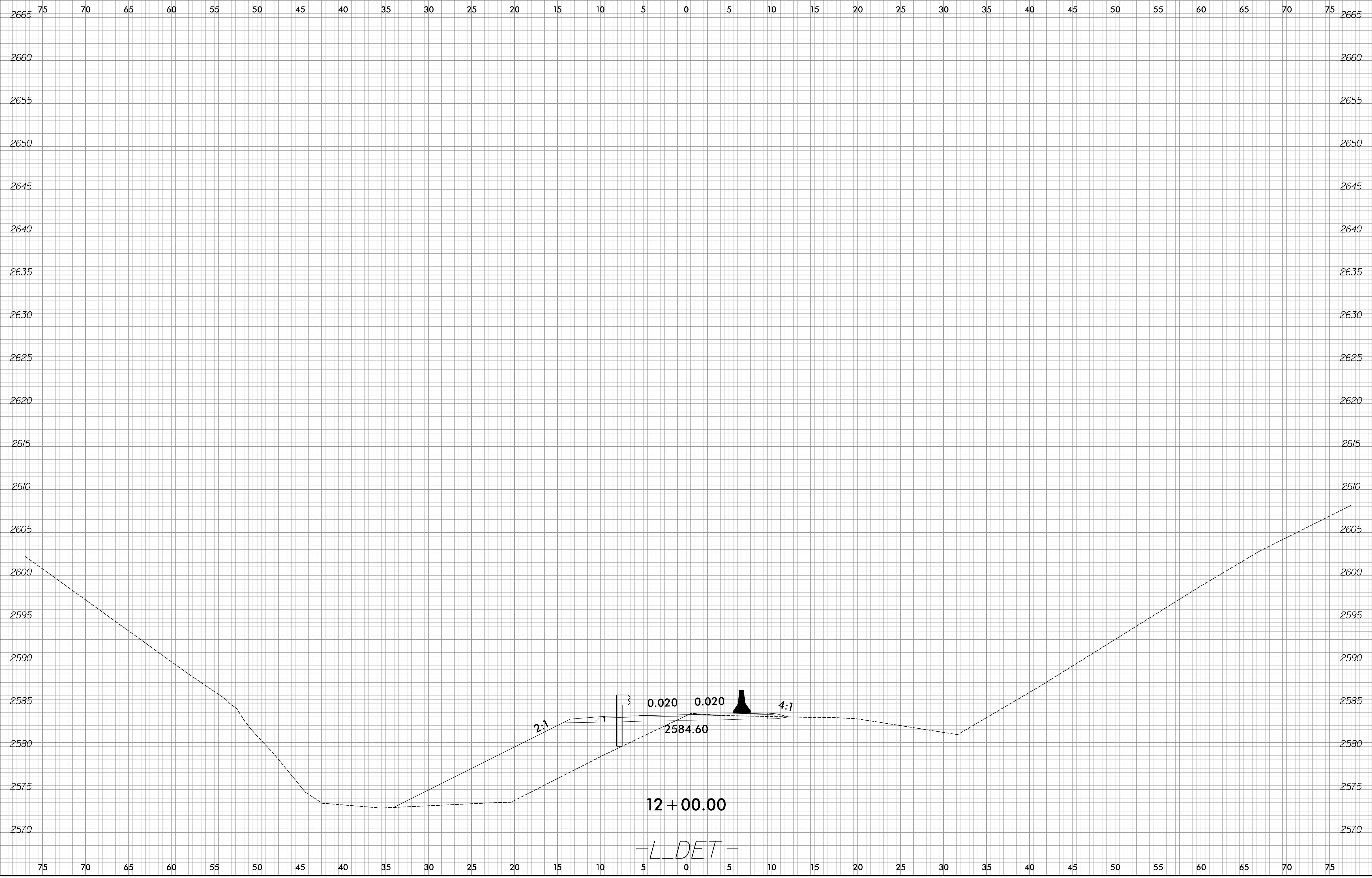

3/15/2022
P:\Roadway\CorridorModeling\RI86_R0Y_XPL_LL_DET.dgn
David.Chiol

6/23/16

	PROJ. REFERENCE NO.	SHEET NO.
	BP14.R004	X-6



3/15/2022
P:\Roadway\Corridor-Modeling\RI86_R0Y_XPL_L_DET.dgn
David.Chiol

6/23/16

	PROJ. REFERENCE NO.	SHEET NO.
	BP14.R004	X-7



3/15/2022
P:\Roadway\Corridor-Modeling\RI86_R0Y_XPL_LL_DET.dgn
David.Chiol

6/23/16

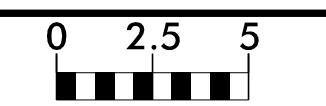

PROJ. REFERENCE NO.	SHEET NO.
BP14.R004	X-8



3/15/2022
P:\Roadway\Corridor-Modeling\RI86_R0Y_XPL_LL_DET.dgn
David.Chiol

6/23/16

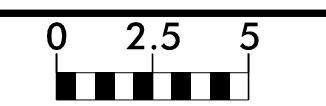

PROJ. REFERENCE NO.	SHEET NO.
BP14.R004	X-9

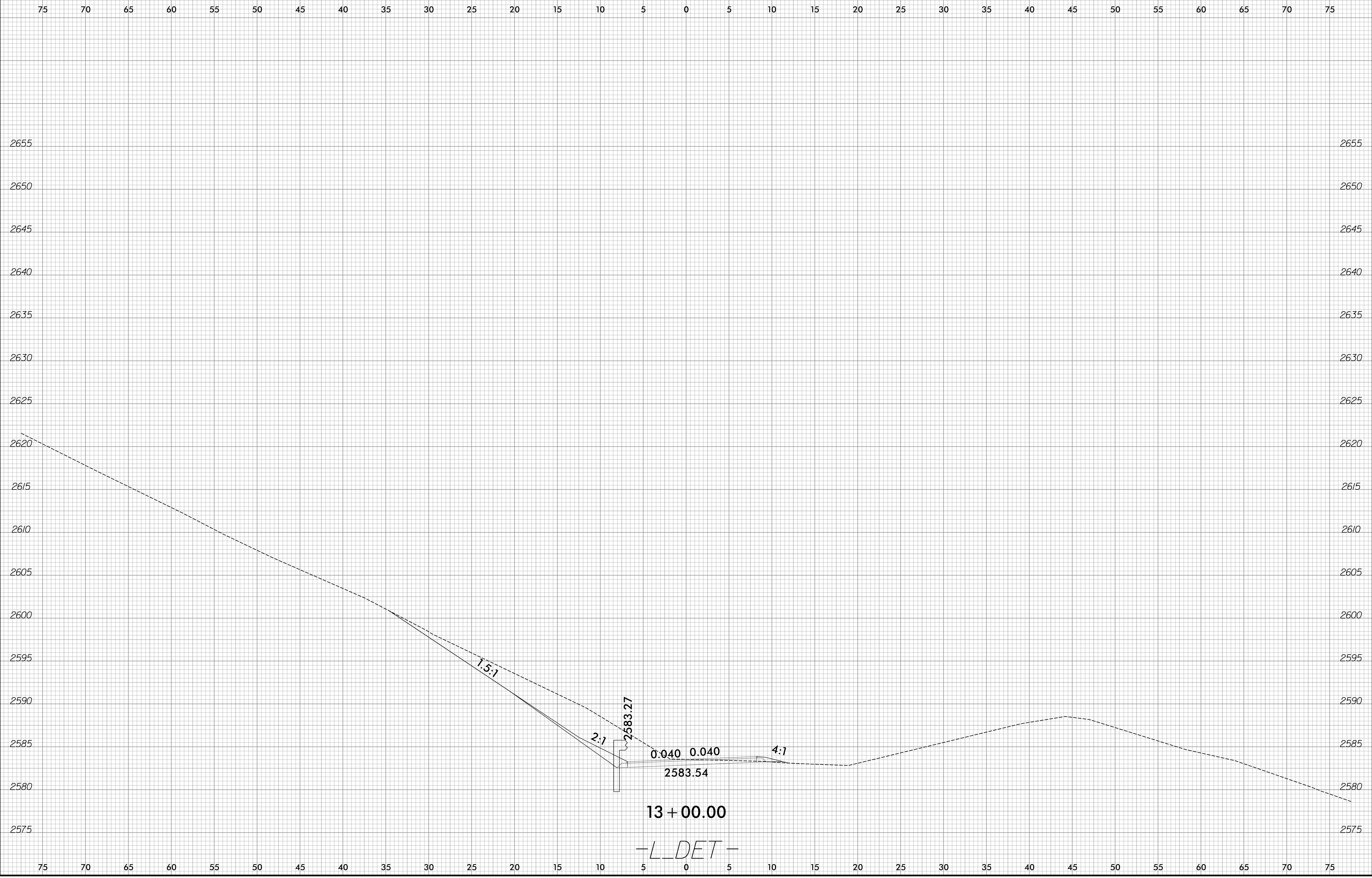

3/15/2022
 P:\Roadway\CorridorModeling\RI86_R0Y_XPL_L_DET.dgn
 David L. Choi

6/23/16

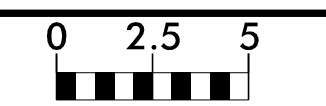

PROJ. REFERENCE NO.	SHEET NO.
BP14.R004	X-10

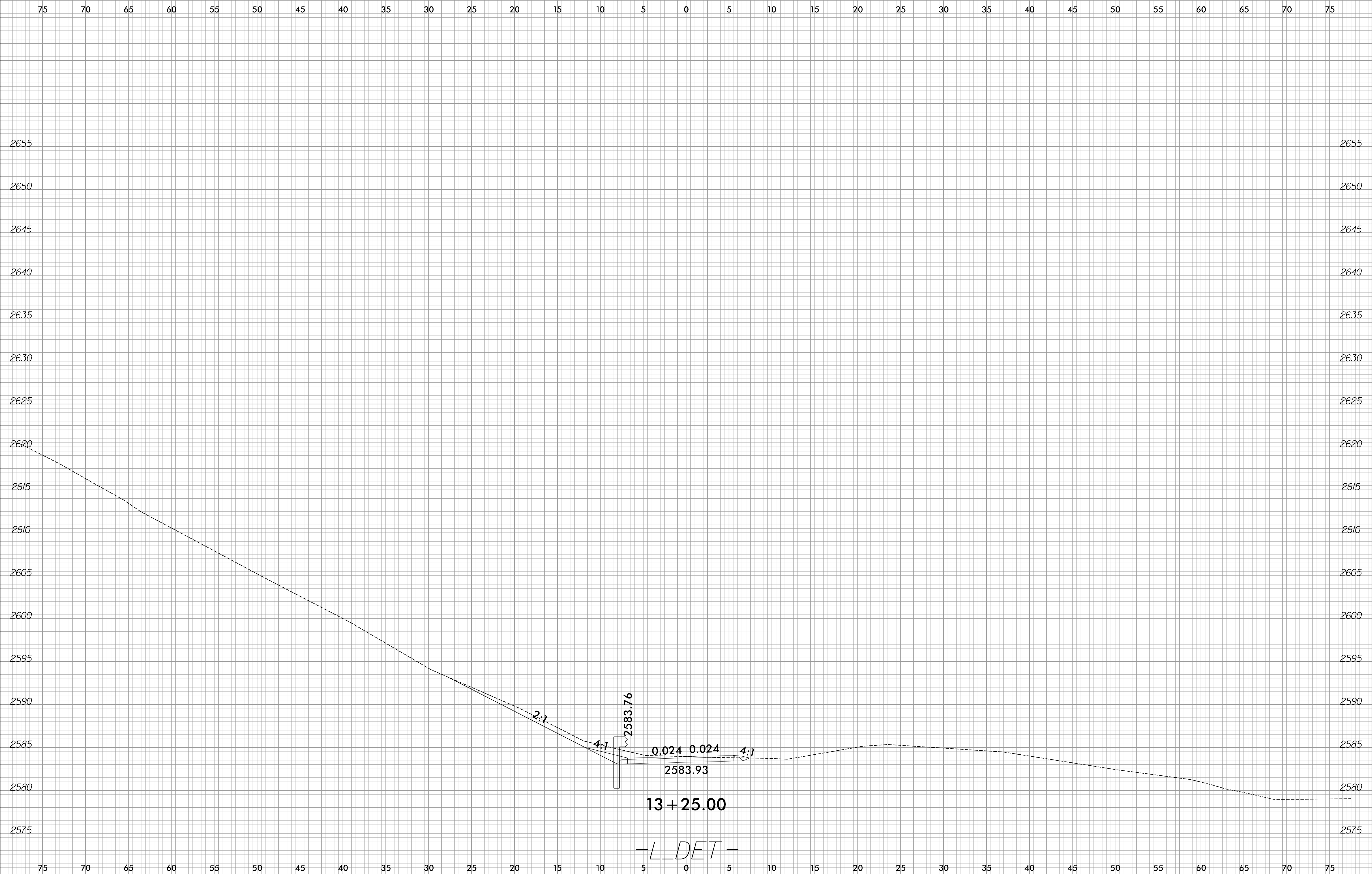

3/15/2022
 P:\Roadway\CorridorModeling\RI86_R0Y_XPL_LL_DET.dgn
 David.Chiol

6/23/16
3/15/2022
P:\Roadway\CorridorModeling\RI86_R0Y_XPL_L_DET_ON_L.dgn
David.Choi

0 2.5 5	PROJ. REFERENCE NO. BP14.R004	SHEET NO. X-11
---------	----------------------------------	-------------------



6/23/16
3/15/2022
P:\Roadway\CorridorModeling\RI86_RDY_XPL_L_DET_ON_L.dgn
David.Choi

0 2.5 5	PROJ. REFERENCE NO. BP14.R004	SHEET NO. X-12
---------	----------------------------------	-------------------



6/23/16

	PROJ. REFERENCE NO.	SHEET NO.
	BP14.R004	X-13

75 70 65 60 55 50 45 40 35 30 25 20 15 10 5 0 5 10 15 20 25 30 35 40 45 50 55 60 65 70 75

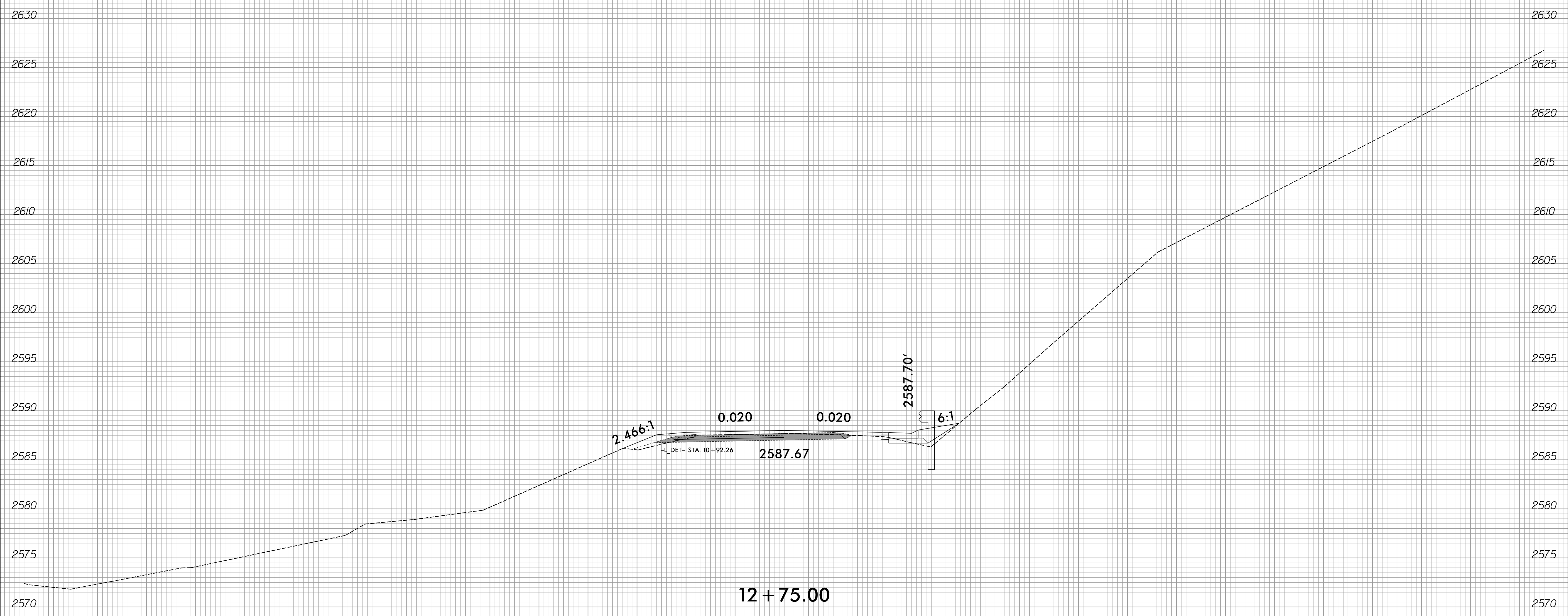

3/15/2022
P:\Roadway\CorridorModeling\RI86_R0Y_XPL_L_DET_ON_L.dgn
David.Chiol

75 70 65 60 55 50 45 40 35 30 25 20 15 10 5 0 5 10 15 20 25 30 35 40 45 50 55 60 65 70 75

6/23/16

	PROJ. REFERENCE NO.	SHEET NO.
	BP14.R004	X-14

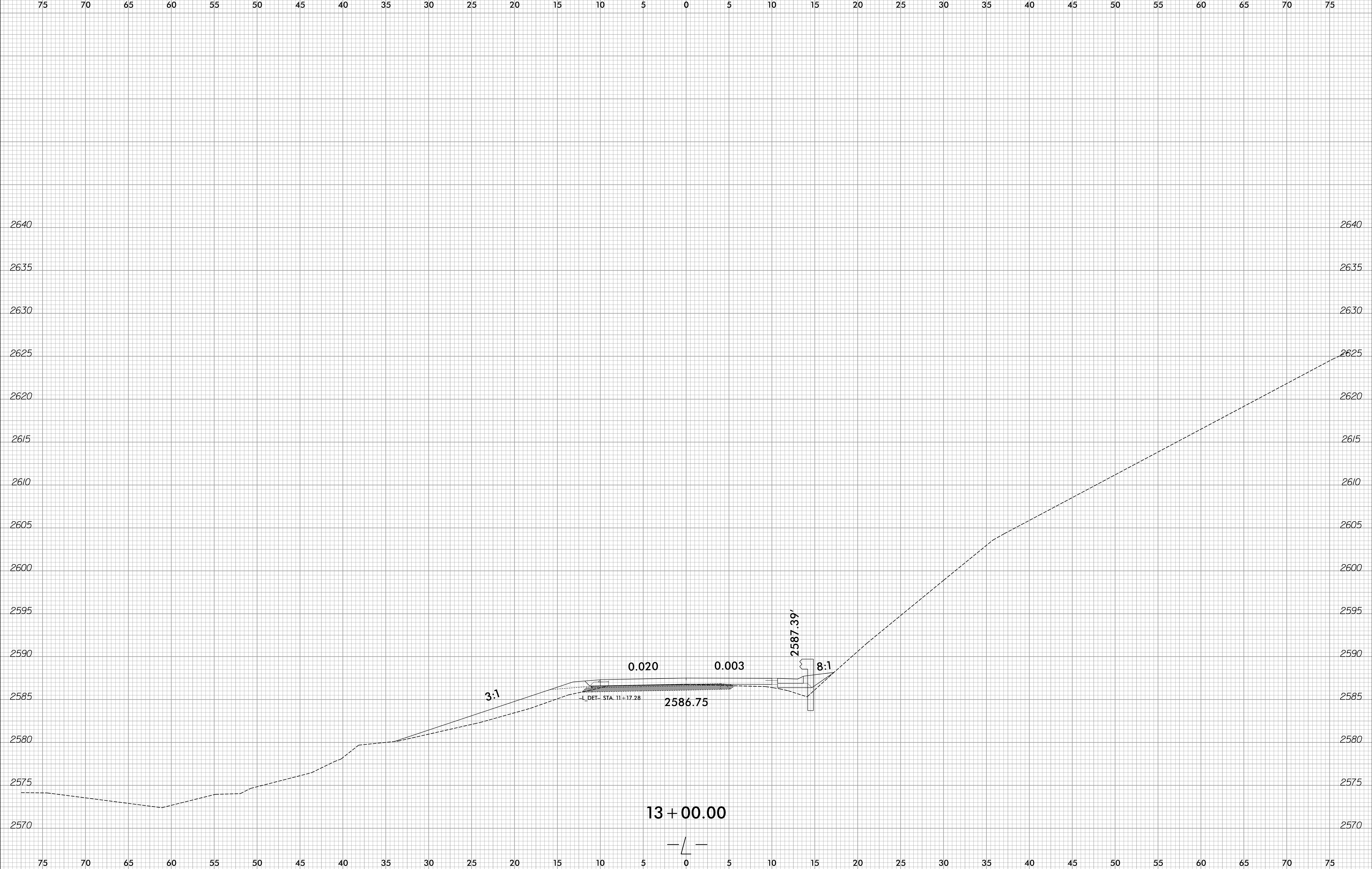

3/15/2022
P:\Roadway\Corridor-Modeling\RI86_R0Y_XPL_L_DET_ON_L.dgn
David.Chiol

6/23/16

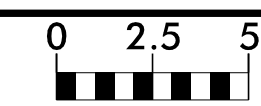

PROJ. REFERENCE NO.	SHEET NO.
BP14.R004	X-15

75 70 65 60 55 50 45 40 35 30 25 20 15 10 5 0 5 10 15 20 25 30 35 40 45 50 55 60 65 70 75

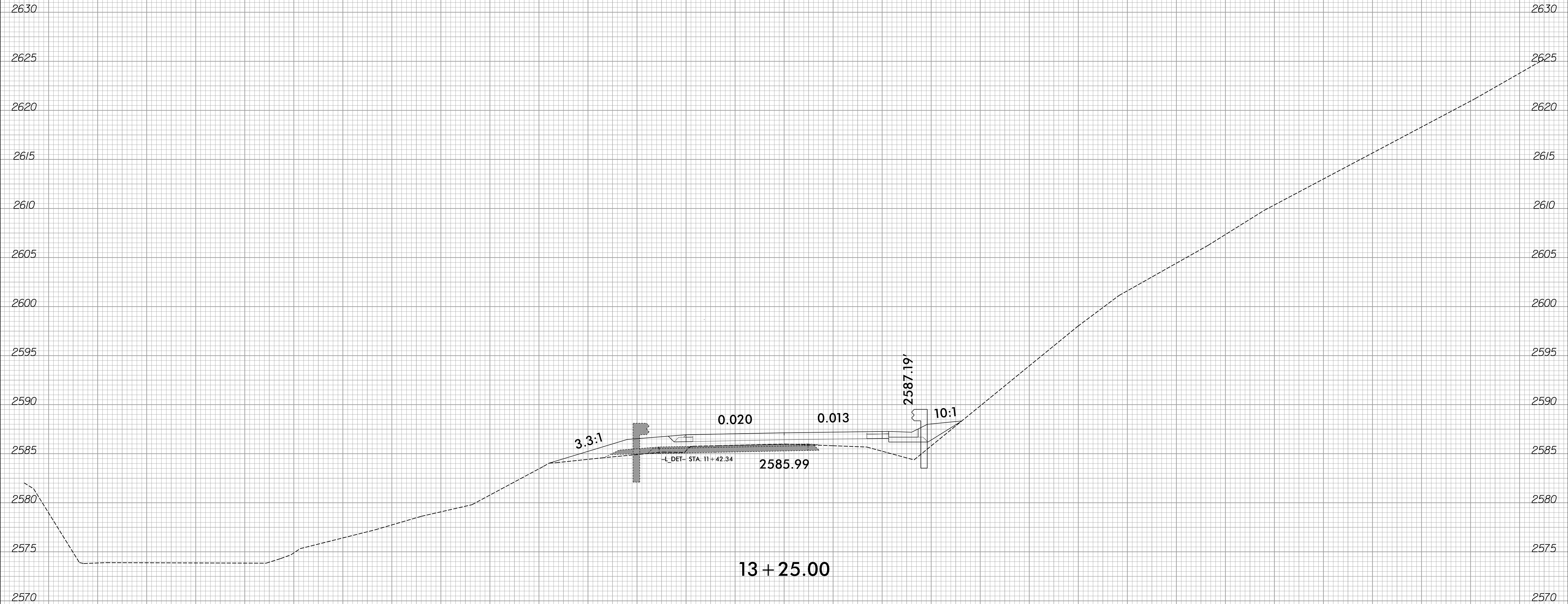

3/15/2022
P:\Roadway\Corridor-Modeling\RI86_R0Y_XPL_L_DET_ON_L.dgn
David.Choi

75 70 65 60 55 50 45 40 35 30 25 20 15 10 5 0 5 10 15 20 25 30 35 40 45 50 55 60 65 70 75

6/23/16

	PROJ. REFERENCE NO.	SHEET NO.
	BP14.R004	X-16

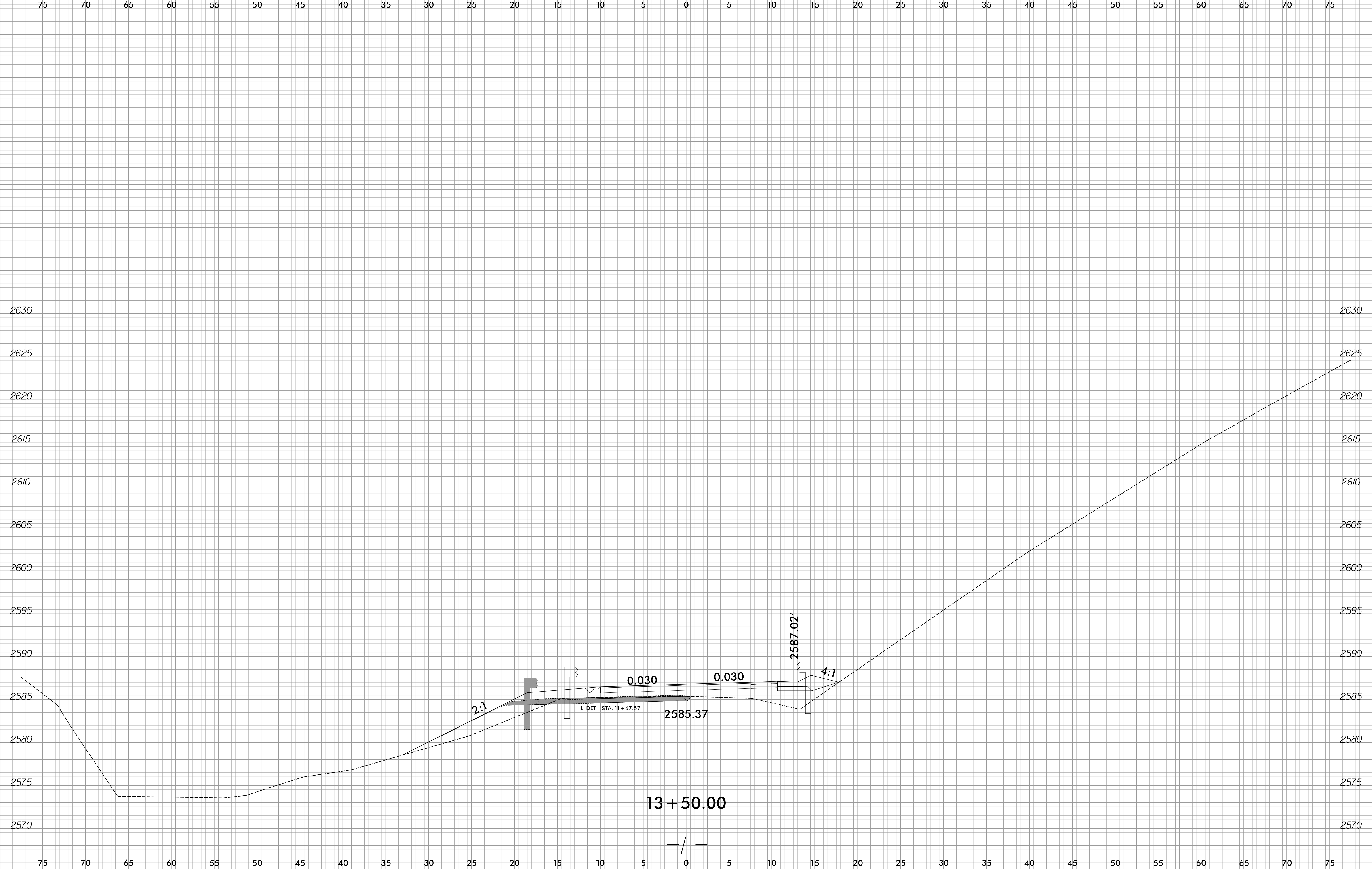

3/15/2022
R:\Roadway\Corridor-Modeling\RI86_R0Y_XPL_L_DET_ON_L.dgn
David.Chiol

6/23/16
3/15/2022
P:\Roadway\Corridor-Modeling\RI86_R0Y_XPL_L_DET_ON_L.dgn
David.Chiol

	PROJ. REFERENCE NO.	SHEET NO.
	BP14.R004	X-17

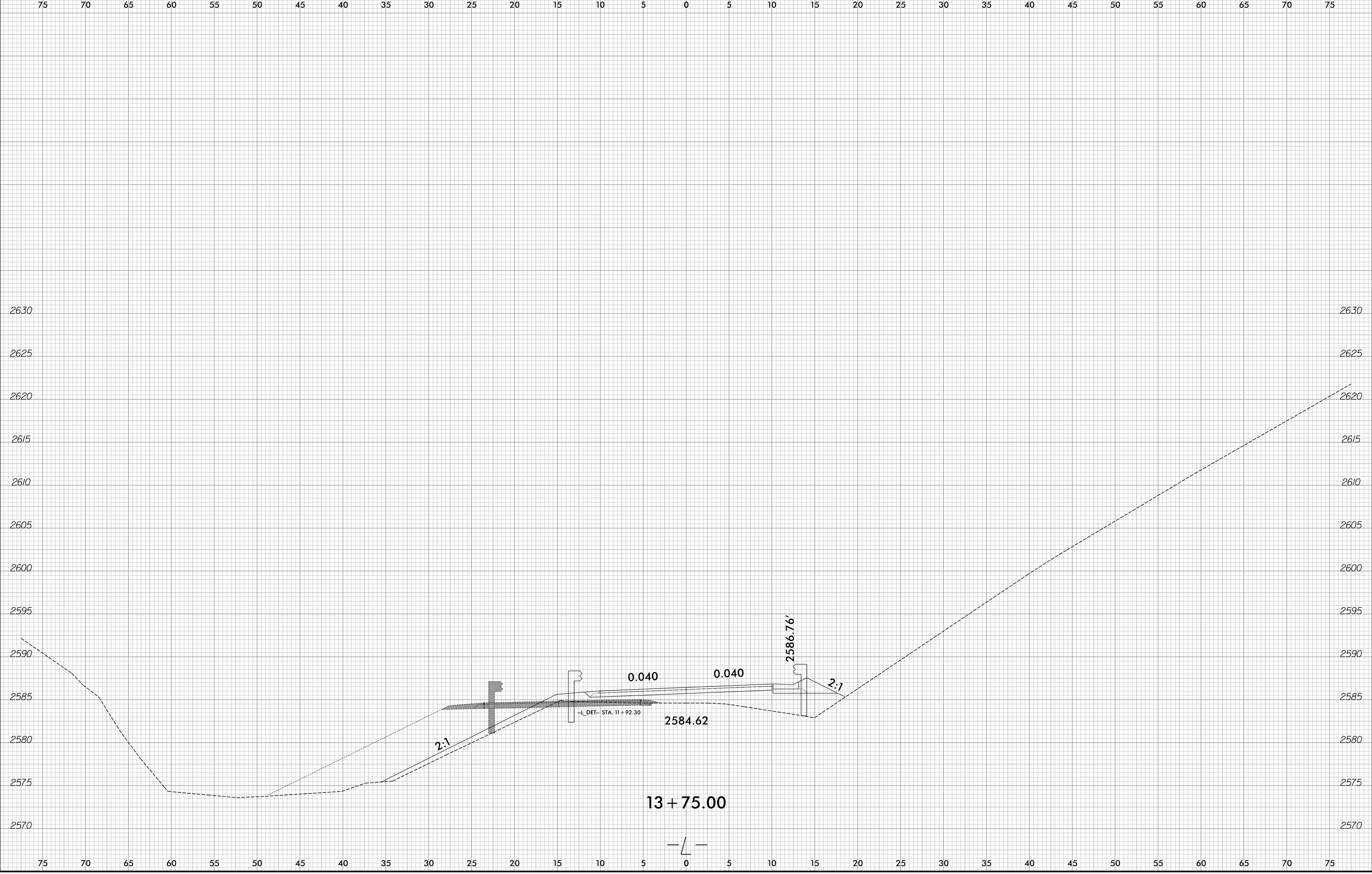

6/23/16

	PROJ. REFERENCE NO.	SHEET NO.
	BP14.R004	X-18

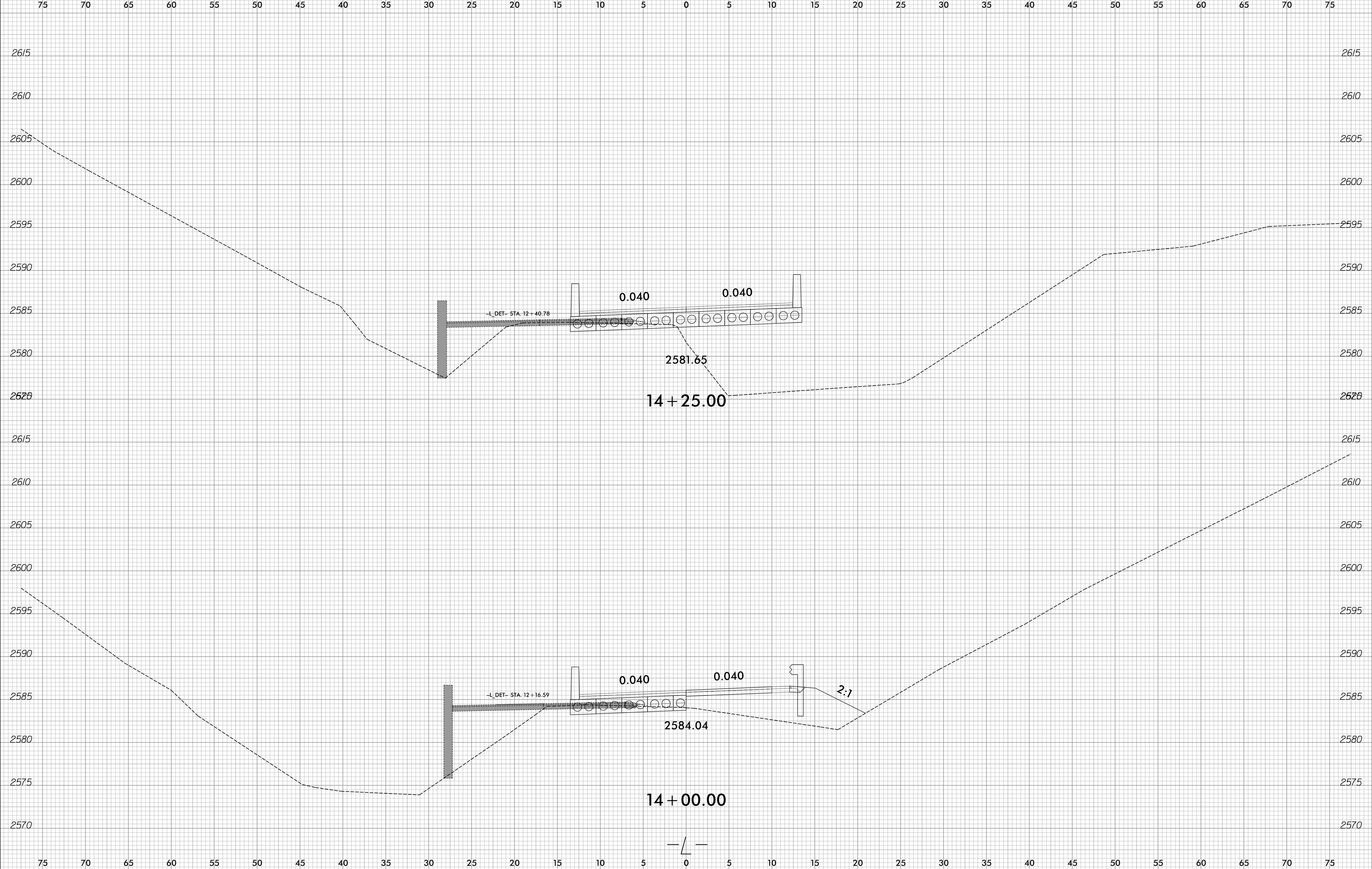

3/15/2022
R:\Roadway\CorridorModeling\RI86_R0Y_XPL_L_DET_ON_L.dgn
David.Chilton

6/23/16

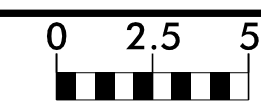

PROJ. REFERENCE NO.	SHEET NO.
BP14.R004	X-19

75 70 65 60 55 50 45 40 35 30 25 20 15 10 5 0 5 10 15 20 25 30 35 40 45 50 55 60 65 70 75

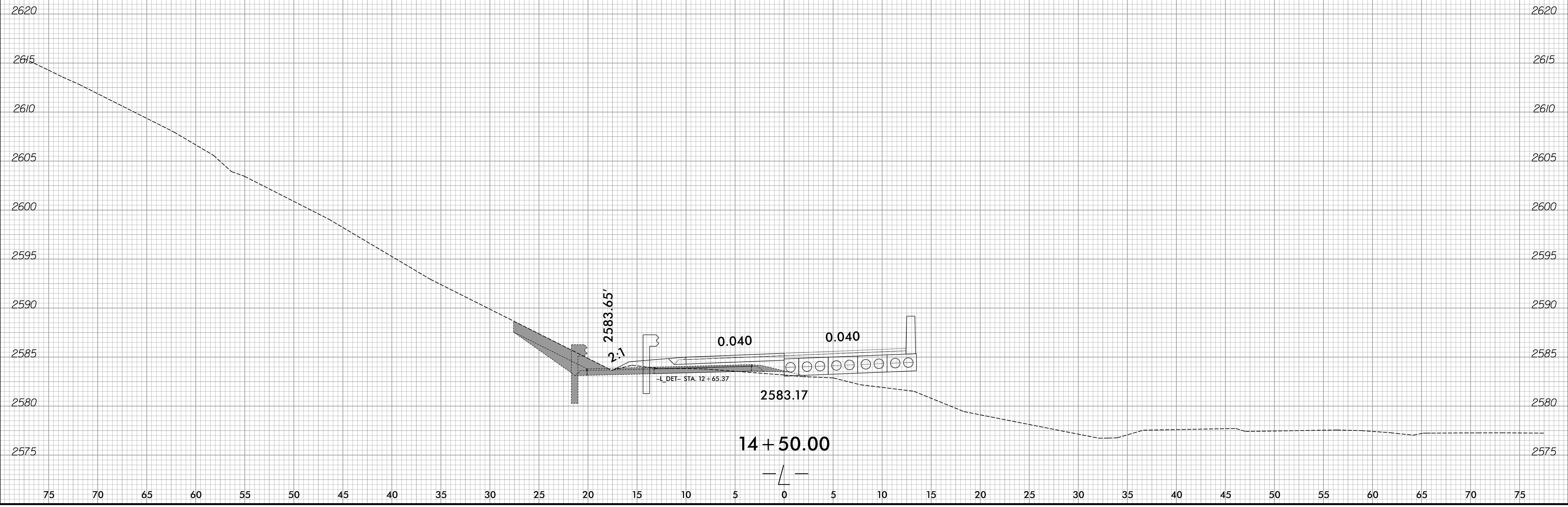

3/15/2022
 P:\Roadway\CorridorModeling\RI86_R0Y_XPL_L_DET_ON_L.dgn
 David.Choi

6/23/16

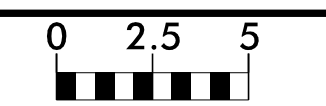

PROJ. REFERENCE NO.	SHEET NO.
BP14.R004	X-20

75 70 65 60 55 50 45 40 35 30 25 20 15 10 5 0 5 10 15 20 25 30 35 40 45 50 55 60 65 70 75

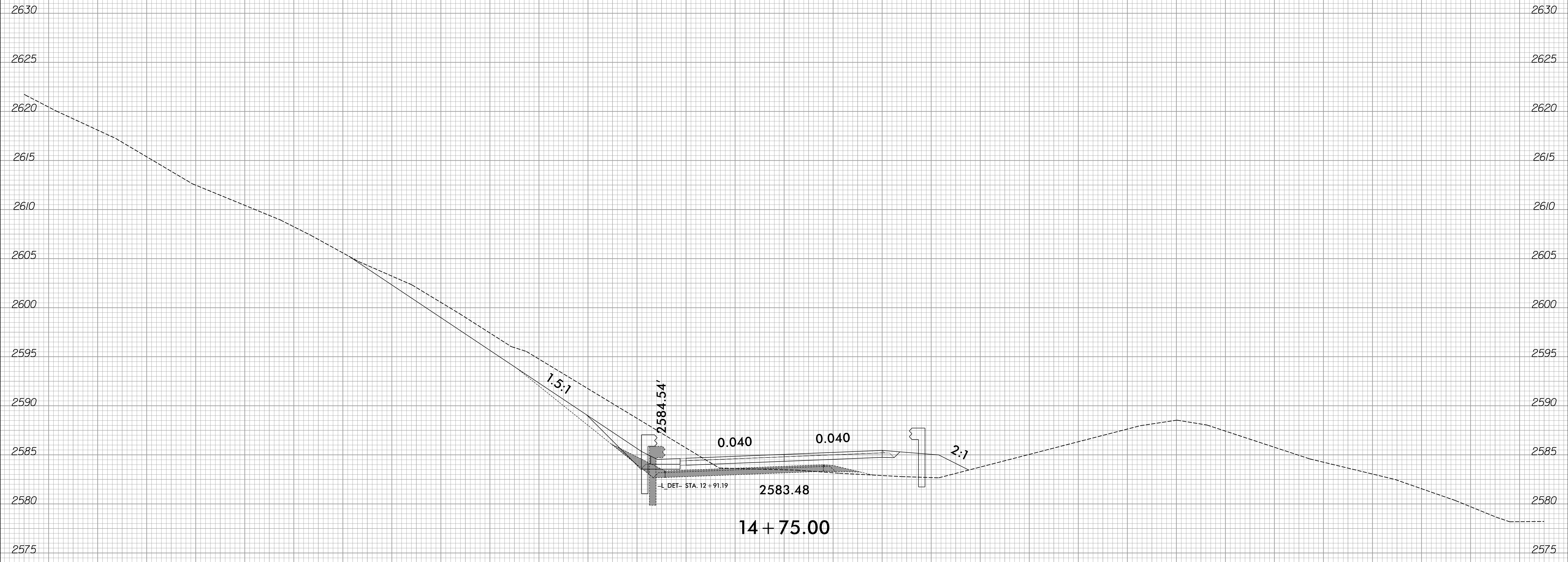

3/15/2022
 R:\Roadway\CorridorModeling\RI86_R0Y_XPL_L_DET_ON_L.dgn
 David.Chiol

75 70 65 60 55 50 45 40 35 30 25 20 15 10 5 0 5 10 15 20 25 30 35 40 45 50 55 60 65 70 75

6/23/16

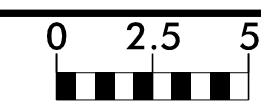

PROJ. REFERENCE NO.	SHEET NO.
BP14.R004	X-21

75 70 65 60 55 50 45 40 35 30 25 20 15 10 5 0 5 10 15 20 25 30 35 40 45 50 55 60 65 70 75

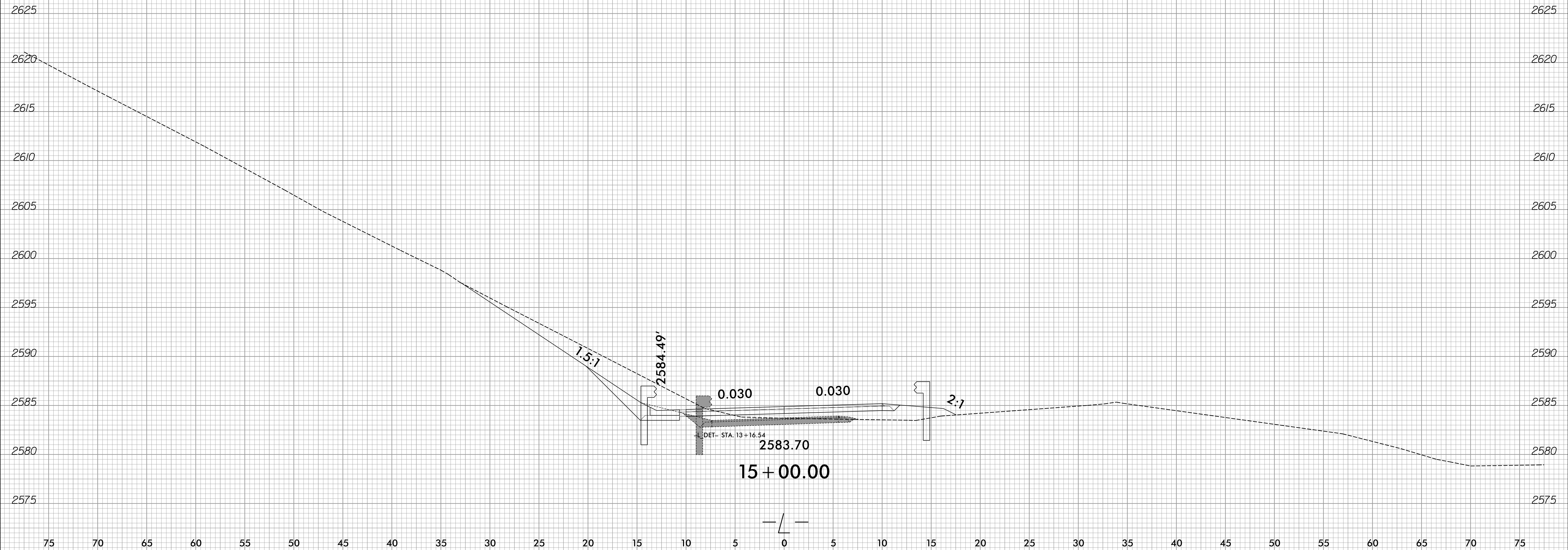

3/15/2022
 P:\Roadway\CorridorModeling\RI86.RDY_XPL_L_DET_ON_L.dgn
 David.Chiol

6/23/16

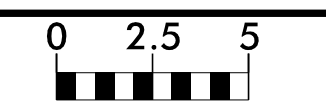

PROJ. REFERENCE NO.	SHEET NO.
BP14.R004	X-22

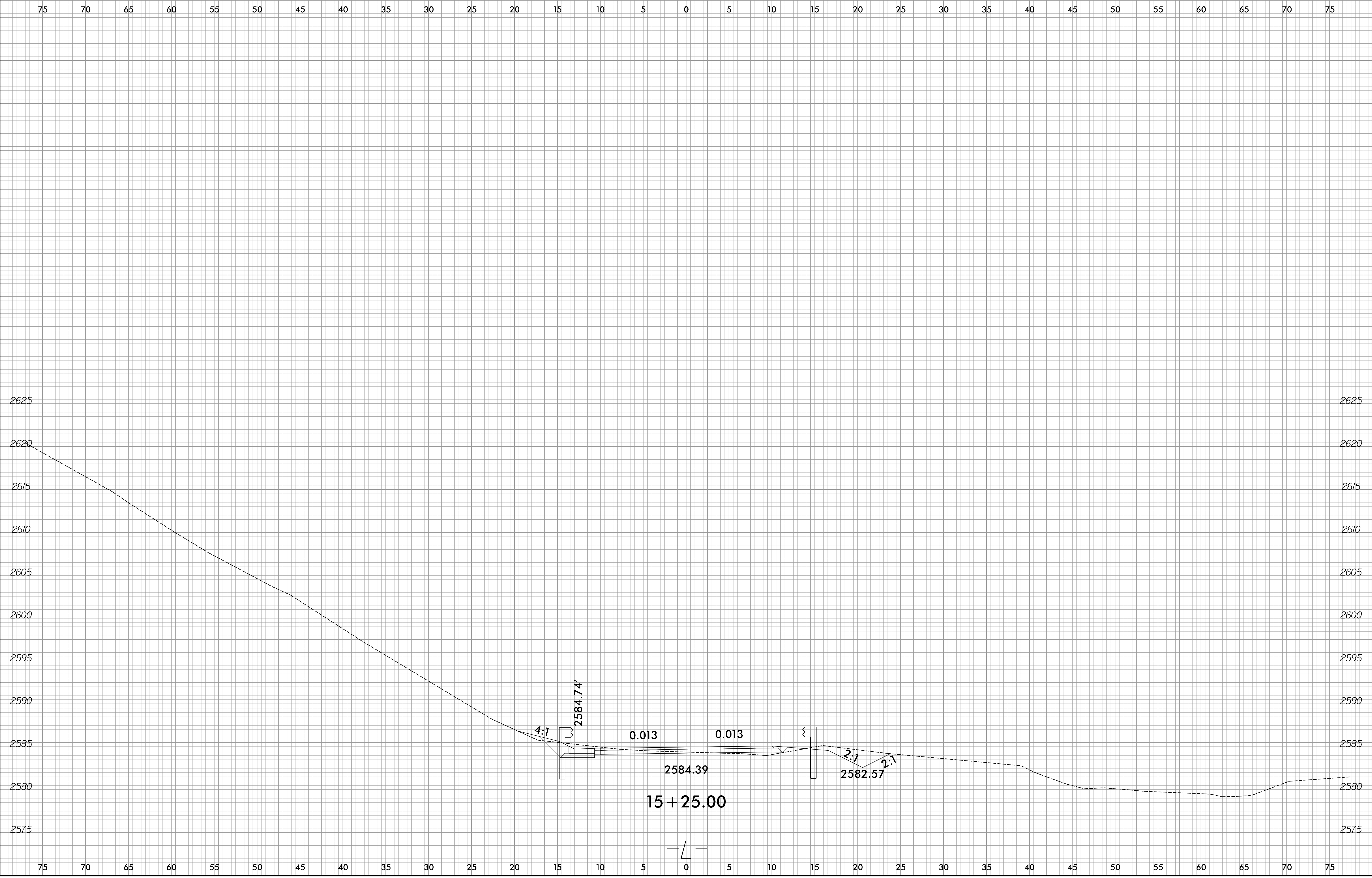

3/15/2022
 P:\Roadway\CorridorModeling\RI86_R0Y_XPL_L_DET_ON_L.dgn
 David.Chiol

6/23/16

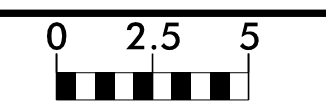

PROJ. REFERENCE NO.	SHEET NO.
BP14.R004	X-23

75 70 65 60 55 50 45 40 35 30 25 20 15 10 5 0 5 10 15 20 25 30 35 40 45 50 55 60 65 70 75

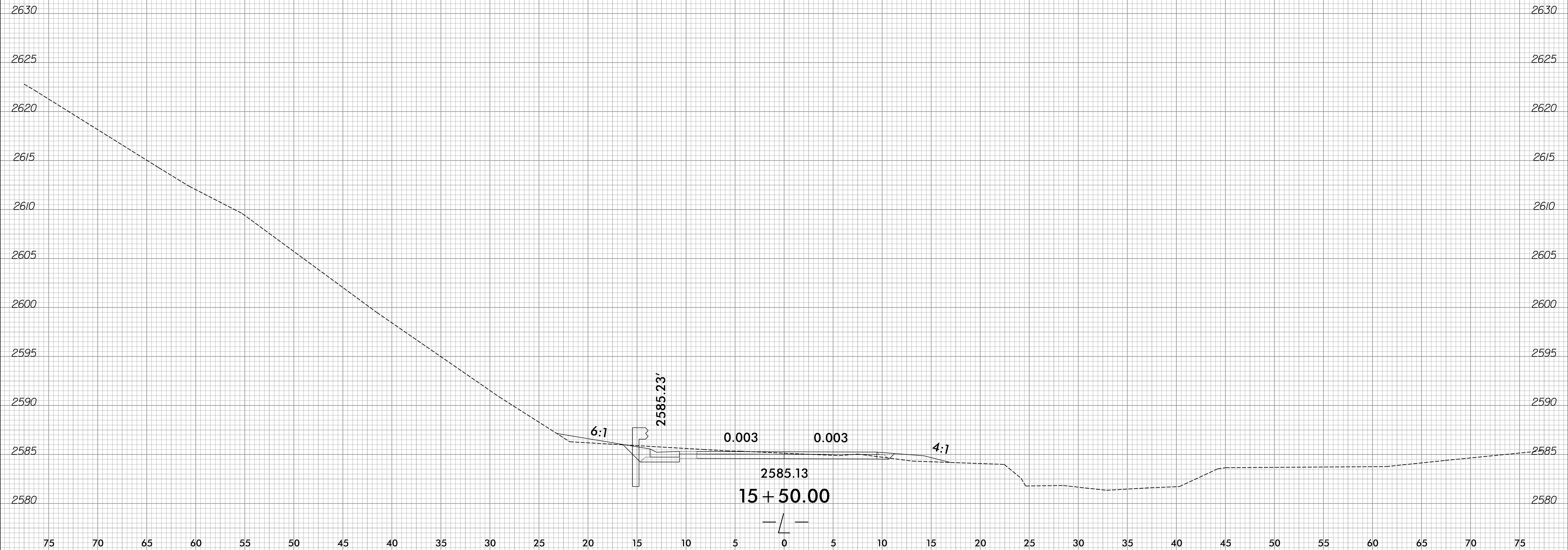

3/15/2022
P:\Roadway\CorridorModeling\RI86_R0Y_XPL_L_DET_ON_L.dgn
David.Choi

6/23/16

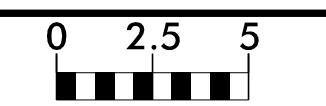

PROJ. REFERENCE NO.	SHEET NO.
BP14.R004	X-24

75 70 65 60 55 50 45 40 35 30 25 20 15 10 5 0 5 10 15 20 25 30 35 40 45 50 55 60 65 70 75

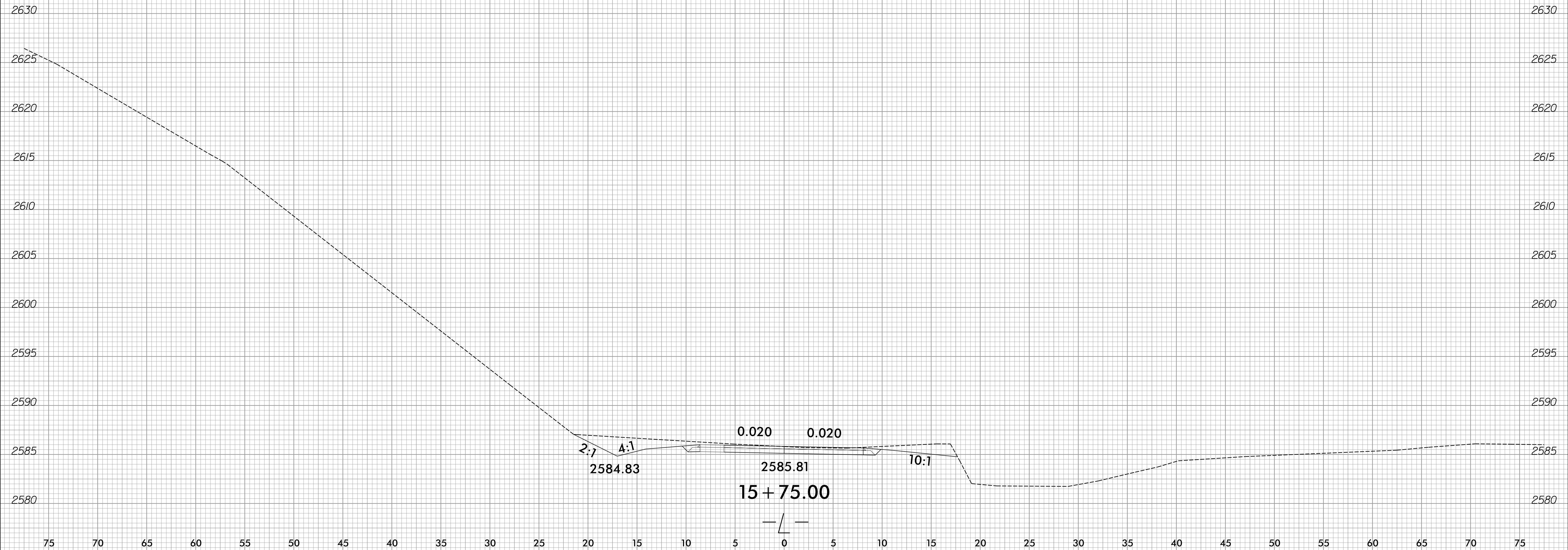

3/15/2022
 P:\Roadway\Corridor-Modeling\RI86_R0Y_XPL_L_DET_ON_L.dgn
 David.Chiol

6/23/16

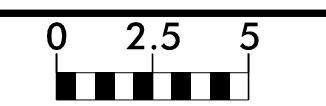

PROJ. REFERENCE NO.	SHEET NO.
BP14.R004	X-25

75 70 65 60 55 50 45 40 35 30 25 20 15 10 5 0 5 10 15 20 25 30 35 40 45 50 55 60 65 70 75

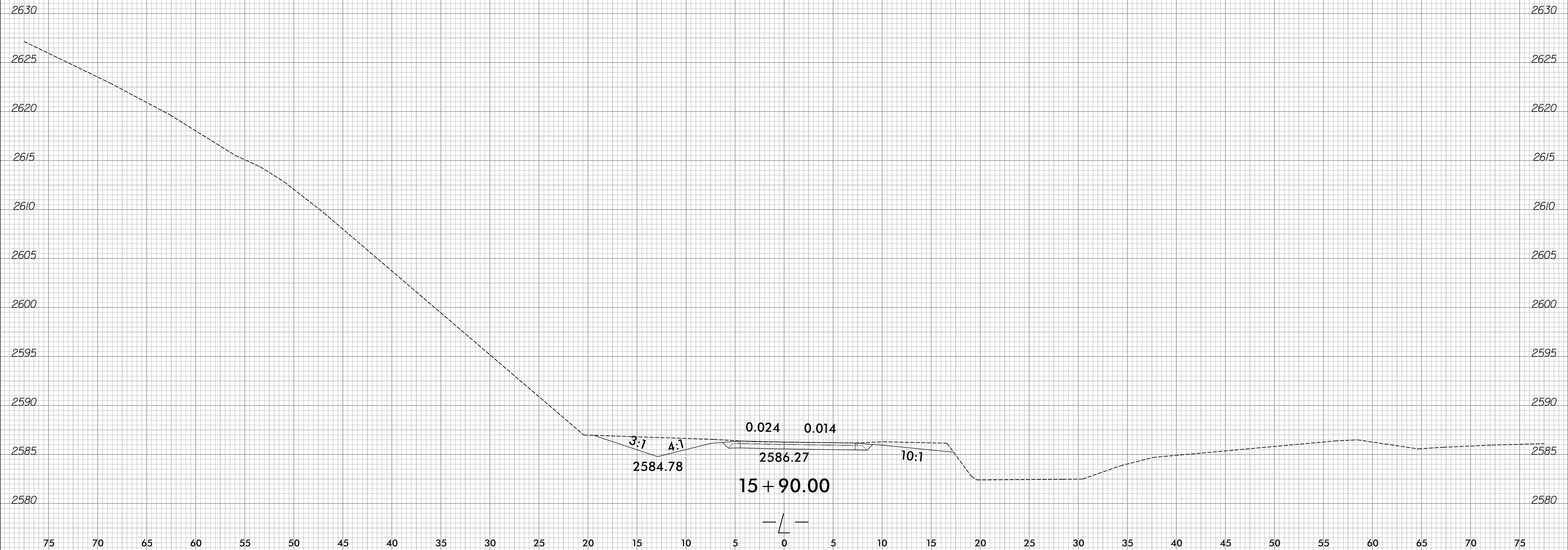

3/15/2022
 P:\Roadway\CorridorModeling\RI86_R0Y_XPL_L_DET_ON_L.dgn
 David.Choi